

## Quick Setup Guide for G2-5 Shooters-Pac

For help with this G2-5 Shooters-Pac, call Dave at 765-427-2753 or Steve at 765-427-4699.

### Charge Batteries Now

### Target Frame

You'll need to have a suitable target frame for mounting the G2 system. It can be a manually operated "pit" system, or a fixed frame. A solid frame is the key to repeatable accuracy. You can mount the target equipment on an existing frame, or build a new frame.

1. Your frame should be solid, and not move excessively with wind or bullet impacts. It should be mounted securely, or have a rigid stand if it's portable.
2. It should be large enough so sensors don't get shot and you can easily mount your largest targets. The G2 and the lower sensor elements should be mounted below grade so they are not able to be shot.
3. Cardboard or corrugated plastic (more weather resistant) work well for a backer board. Coroplast is available at most home improvement stores.

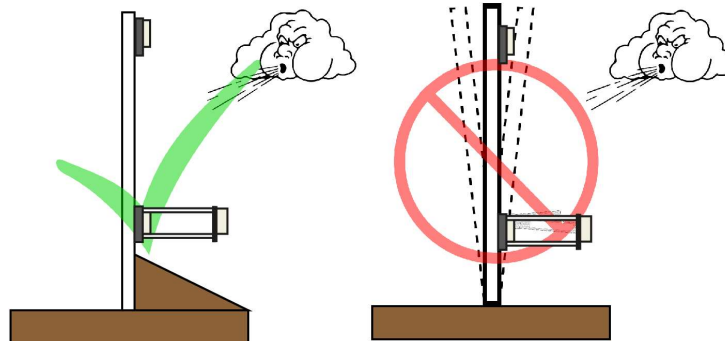

The microphone sensor elements are mounted in the four corners of your target frame, and the G2 (yellow housing) is mounted near the bottom of your frame, out of the line of fire. The G2's panel antenna communicates to the line, and needs to be mounted about 1/3 or 1/2 way up the left side of the frame, with clear line of sight to the firing line. The lower sensor elements should also be below the line of fire.

### Sensor Mounting Plates

Good, accurate sensor mounting is the key to an accurate system. There are four square plastic mounting plates that get mounted to the four corners of the target frame. The 3 single mics and the one dual mic assembly then slide into these mounting plates.



1. Mount these 4 bases to your target using 2 screws per base, and do not over tighten. You **MUST** install the bases at 90 degrees to each other, so they should be in a rectangular or square orientation.
2. Slide the sensor assemblies into the bases, with the dual assembly in the lower left corner. They should have the BNC connector on the bottom, be mounted in the same plane as each other and the target face, and point at the firing line. The dual sensor in the lower left needs to be aligned to point at the firing line.

- Once mounted, record the horizontal spacing between the left edges of upper bases & the vertical spacing between the tops of the left bases

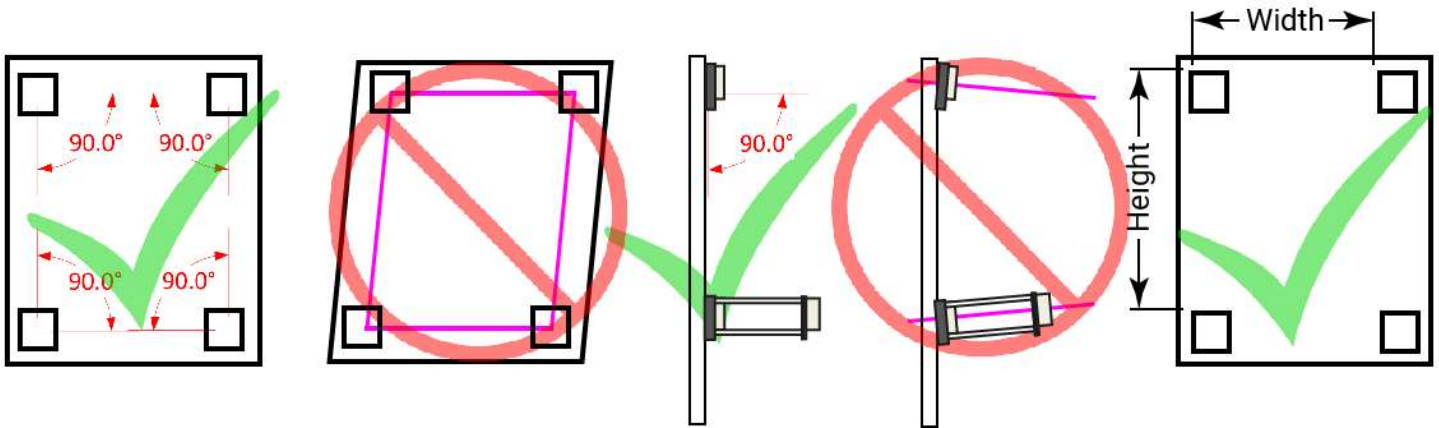

## Targets

Fasten a target face to the frame, roughly near the center of the bases

## Wiring Harness

The wiring harness connects to the G2 and to all 5 of the sensor elements. You'll notice the upper sensors are connected via separate cables called "drop cables". These provide for a less expensive replacement cost than the entire cable assembly, in case they get shot. They are exposed to incoming rounds.

Connect the harness to each of the 5 sensor assemblies, then to the G2, making sure the multi-pin connector is seated well. Next connect the antenna cable to the antenna connection on the G2 and the panel antenna. Hang the panel antenna on the left side of the target frame, about 1/3 or 1/2 way up the left side. Keep it as far left as possible to reduce the chance of bullet impacts.

Insert a freshly charged battery into the G2. The battery positive terminal goes in first. Power on the G2, and note the number written on the battery cap. You'll need that number when logging into the system. It needs about 1-2

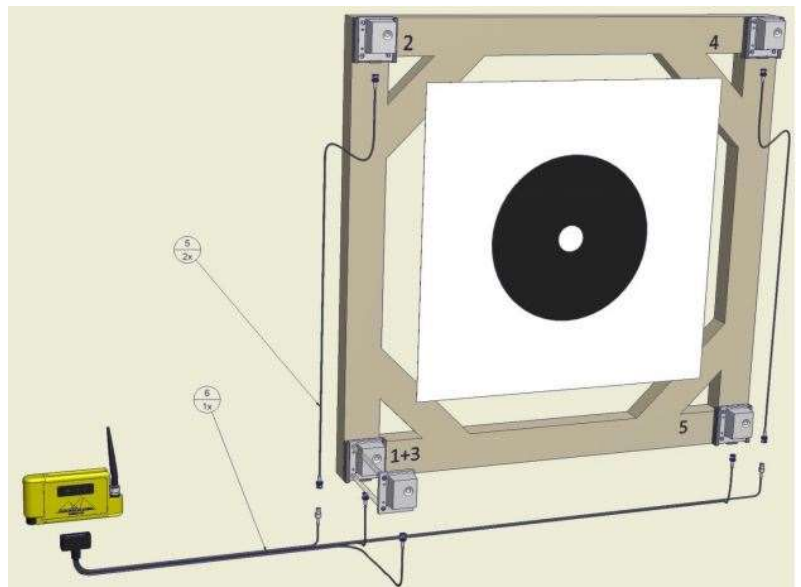

minutes to fully come online. Insert a freshly charged battery into the R5 repeater and power it on. The R5 repeater goes to the firing line.



## Connecting Your Display Device

Almost any display device with WIFI capability and a modern browser (laptop, tablet, smartphone, etc.), may be used to connect to the target system.

1. First, connect to the WIFI Network. Choose "Settings", then "WIFI" or "Connections", and look for a WIFI network named **SilverMountainTargets**, and click "connect".
2. Open a browser such as Safari, Chrome, or Firefox & in the Address bar, type in the IP address of the target, 192.168.0.XX, where the "XX" is the number written on the battery cap of the G2. The TargetViewer should now load. Note that older outdated browsers may not work correctly, so make sure yours is updated.

## Initial Setup of the System

We need to input the sensor spacing you recorded earlier (width & height of the mounting plates) so the system can correctly calculate bullet position. Click on the "Gear" Icon.



A password box will appear, enter "becareful", all lower case, all one word. Click on the "Frame & Wrench" Icon.



Click on "Mic W,H:" and enter your mic width and height, use only mm with no decimal points, and one space between then numbers (MM=inches x 25.4). Example: 1754 1537. Check that your numbers are correct, and click OK. Lastly, make sure you are connected to the target frame. The yellow box at the bottom of the screen should have the target name highlighted in green, and the top right of the screen should also be highlighted in green.

Click the yellow "back" button to return to the main menu.

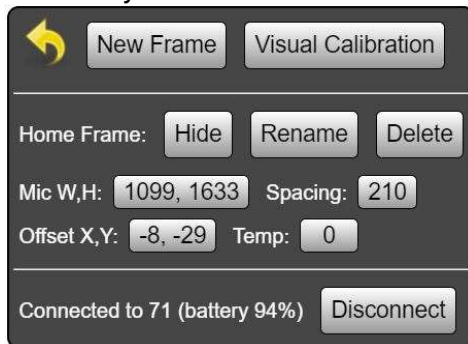

## Firing Line

Go to the firing line and make sure your R-5 repeater is on. Face it toward the target, and keep it up off the ground. Typically, you can mount the R5 mounting base on a scope stand, or set it on a bench or shooting cart. Check your target display and make sure you're connected. (red x on the screen means you have lost connection).

Click on the "Target & Wrench" icon. Highlight the targets you want to use.



Click on the “Whistle & Wrench” icon to activate one of your pre-selected targets for this shooting session, and to setup strings of fire if desired.

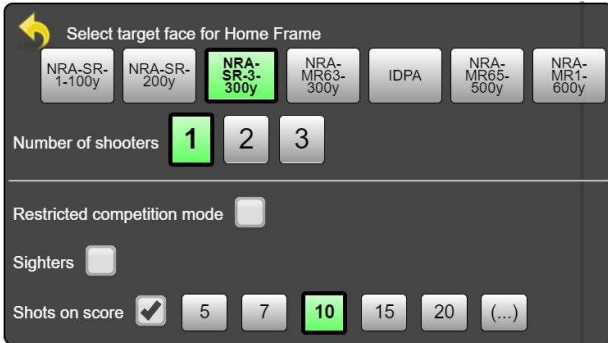

## Calibration

Use these procedures to align the e-target’s coordinate system with the physical center of the installed target face. This should only be required on the first installation of sensor mounts, or if physical target center has moved.

1. Set up the physical target frame for shooting, using a new target face, or paste all holes
2. Fire one shot within 10” of the center.
3. Go to the physical target and find the bullet hole in paper
4. From the Admin menu, select the Frame & Wrench icon
5. In the ShotsList Column, select the shot that was fired.
  - a. Measure the location of the bullet hole center, on the physical target. As an option, you may draw vertical and horizontal reference lines to assist in measuring
  - b. Record the bullet position as two numbers, X and Y coordinates.
    - i. The X coordinate is how many millimeters the bullet is to the RIGHT of the vertical centerline. If the bullet is LEFT of the vertical centerline, your X coordinate will be a negative number
    - ii. The Y coordinate is how many millimeters the bullet is ABOVE the horizontal centerline. If the bullet is BELOW the horizontal centerline, your Y will be a negative number
  - c. Click the “Calibrate” button in the ShotsList column for the calibration shot. Enter your X and Y values, separated by a space
  - d. CONFIRM that the calibration shot is now shown in the correct position. If not, cancel the shot from the calibration and repeat the calibration by selecting the “calibrate” button again.
6. Note, shot(s) used for a calibration offset calculation are highlighted in yellow, in both the ShotsList and screen display
7. The CANCEL button can remove a shot from calibration calculation

For more information, please contact Dave or Steve at Silver Mountain Targets USA, or log onto the SMT corporate site [www.SilverMountainTargets.com](http://www.SilverMountainTargets.com)